

Fittings

Leg Boss

Adjustable leg

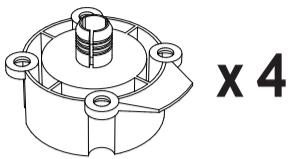

x 4

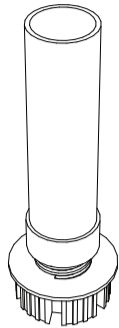

x 4

Plinth Clip

Circular Leg CLip

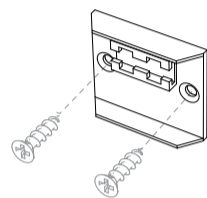

x 2

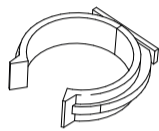

x 2

N 15mm Screws



x 20

- (A) End Panel x 2
- (B) Top/Bottom Panel x 2
- (C) Back Panel x 1
- (D) Top Drawer Front x 1
- (E) Pan Drawer Front x 2

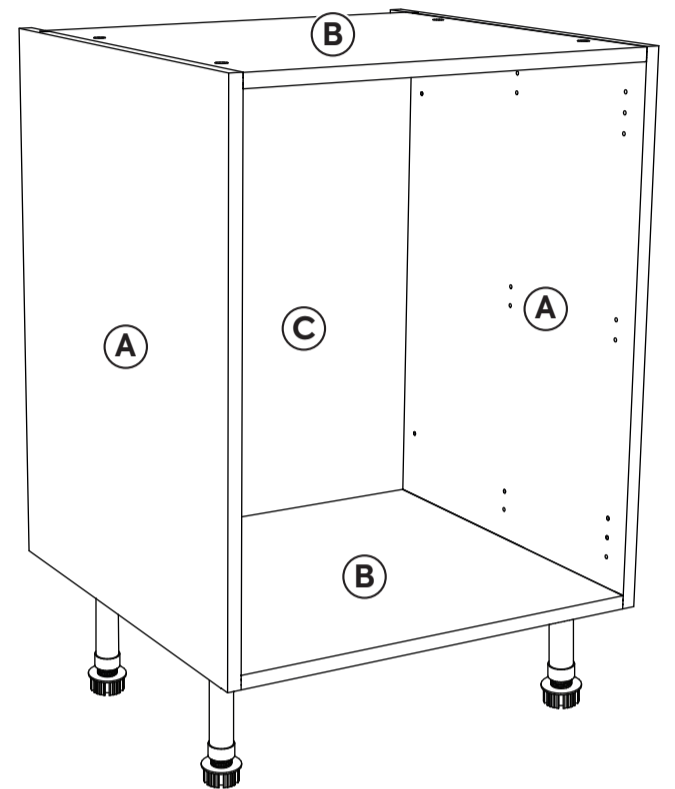
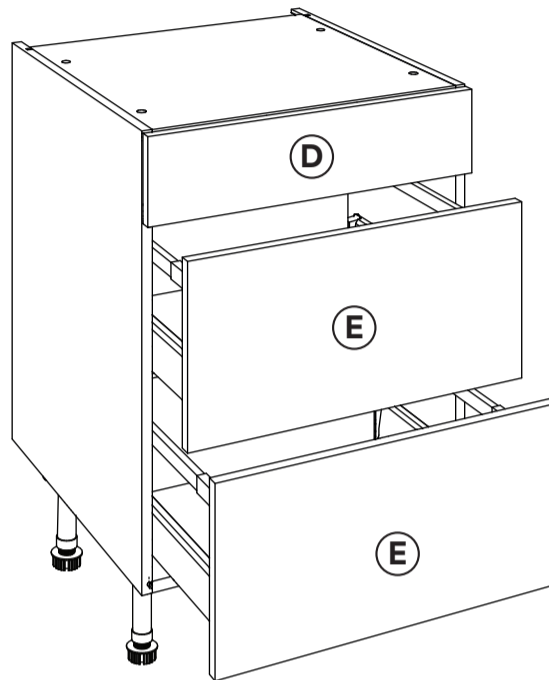

Please Note - Drawer boxes are in a separate pack due to weight

Assembly

- 1** We recommend using PVA glue for additional bond - Simply run a bead of glue along each joint line during the assembly process

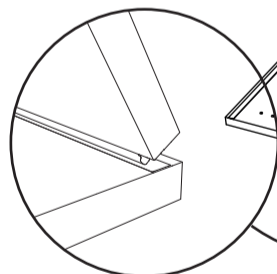
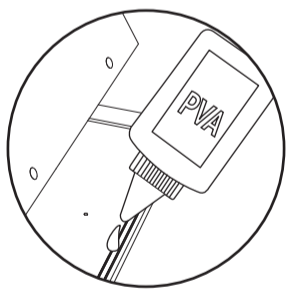

Carefully align front edges

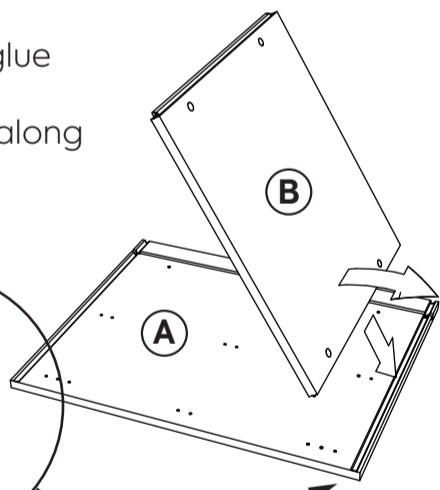

- 2** Tilt the Top/Bottom Panel (B) into position - ensure both grooves are aligned

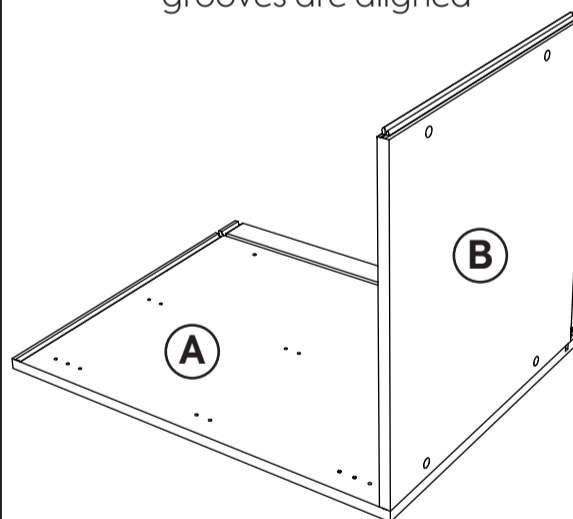

- 3** Fit second Panel (B).

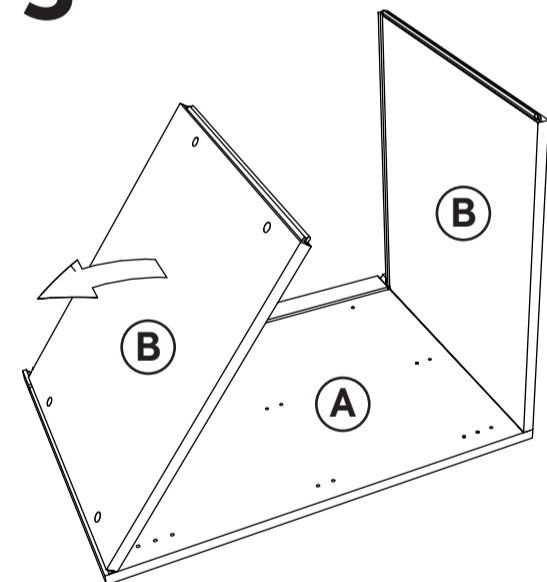

- 4** Slide back panel (C) into place

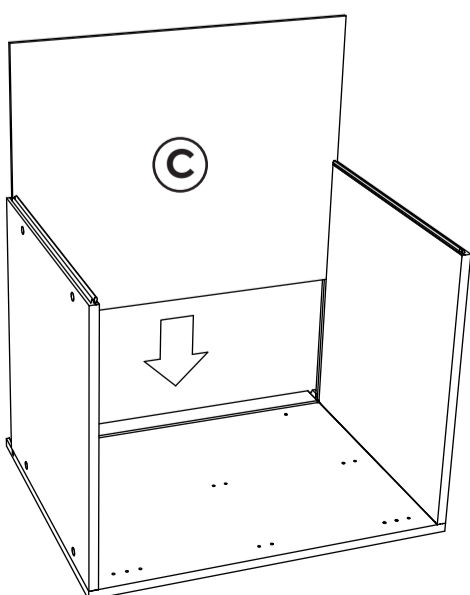

- 5** Locate end panel (A) into position - When all joints and grooves are aligned correctly, tap together using a rubber mallet

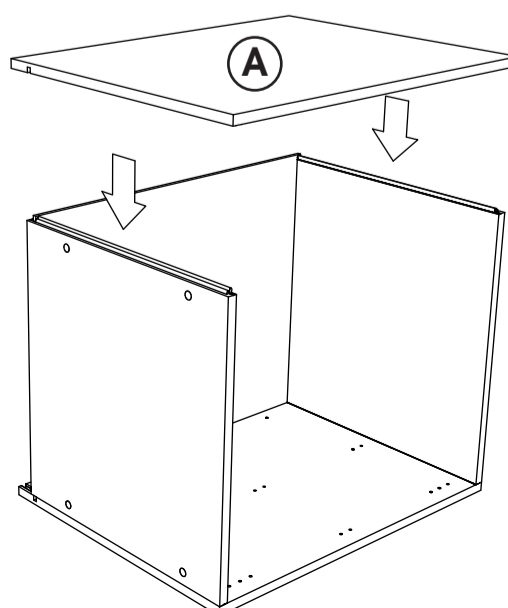

- 6** Push Leg Boss into place with the overhang over the End Panels (A). Once in position tap the centre dowel with a soft rubber mallet to secure.

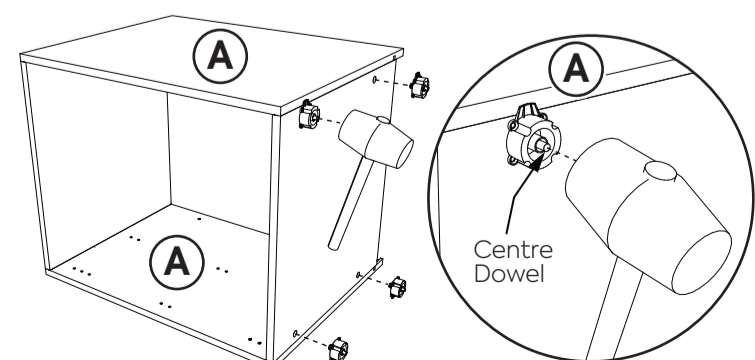

7 Screw leg boss in place

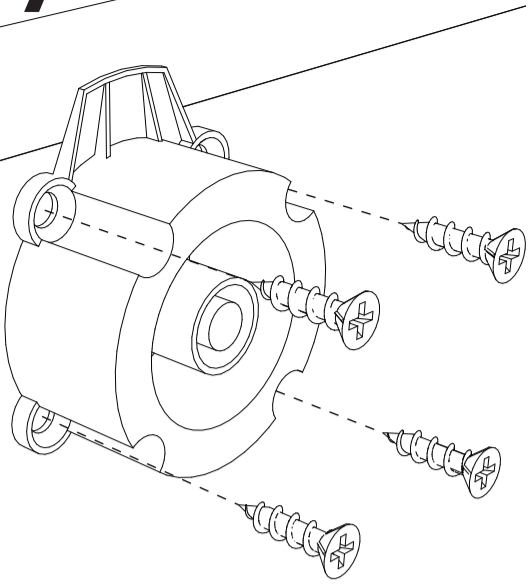

8 Insert adjustable legs into leg boss

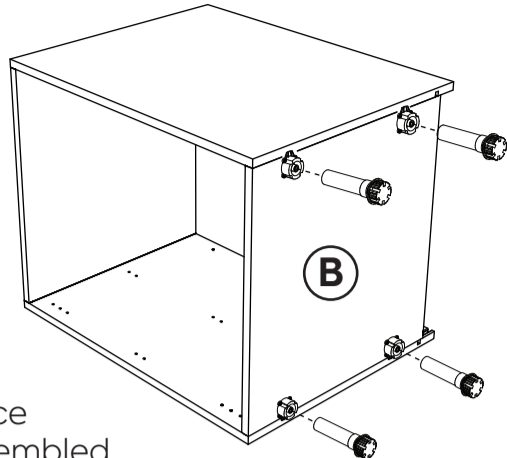

Once assembled, measure and adjust feet to 150mm

9 Attach Plinth Clip to plinth using 15mm screws (N) then slide Circular Leg Clip into Plinth Clip. Using clips fix plinth to legs.

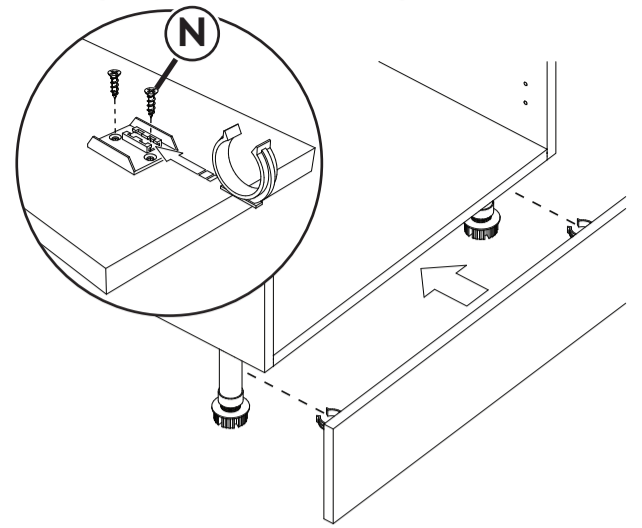

10 Fit the Runners (A) to the inside of the cabinet using the pre-drilled holes in end panel as shown.

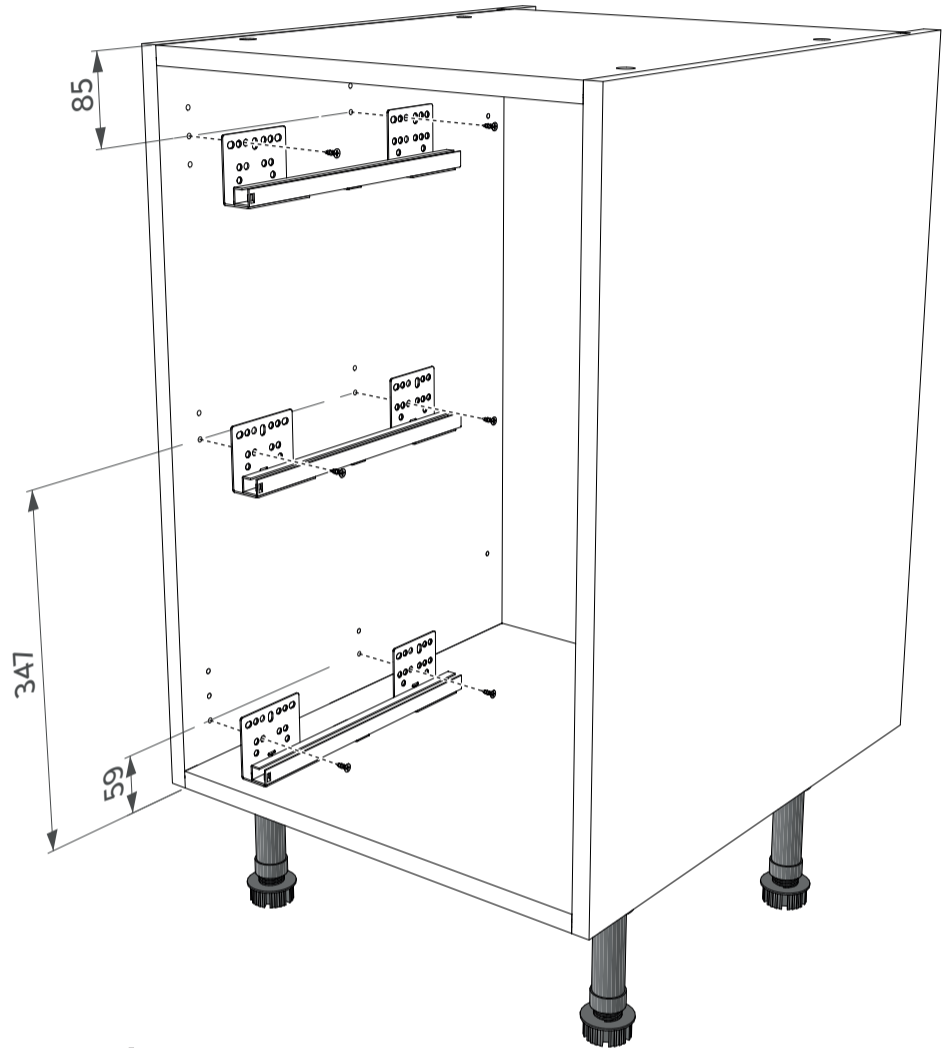

Which holes to use on the cabinet

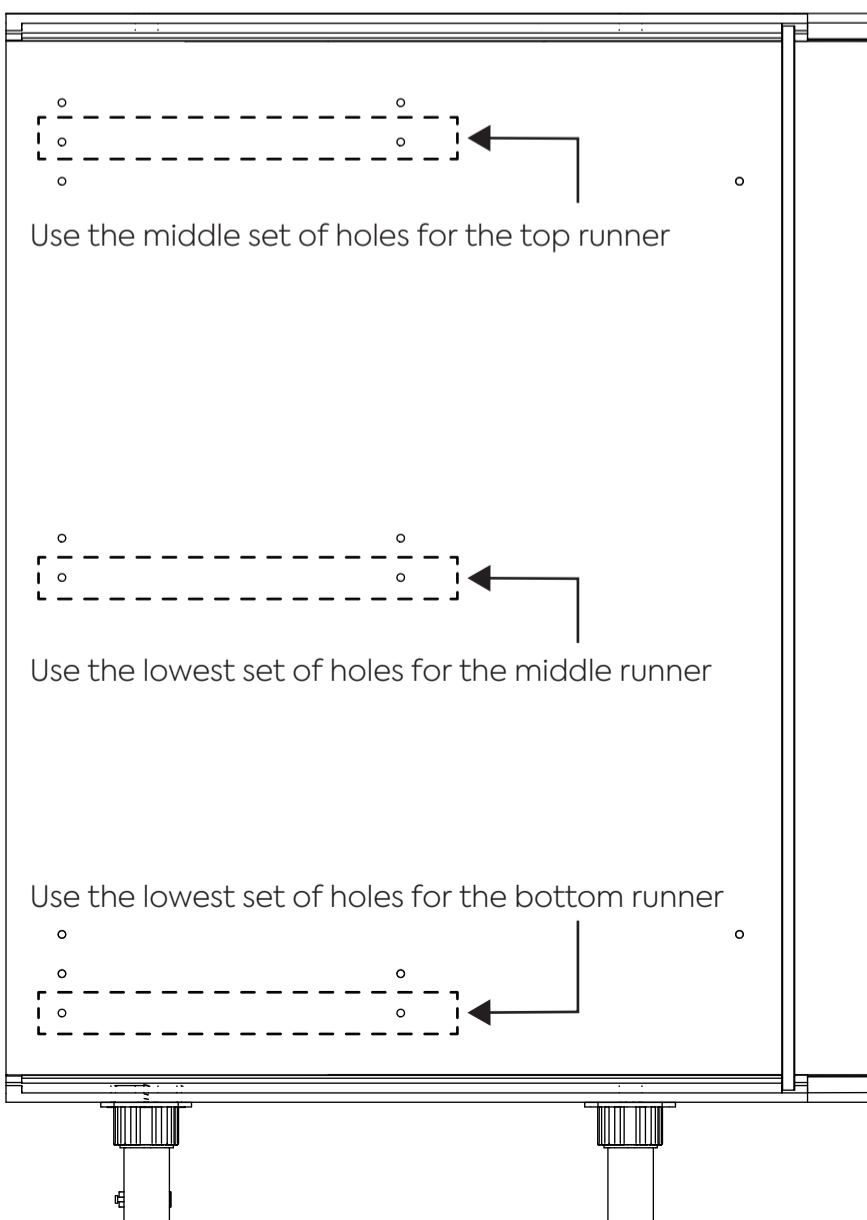

Which holes to use on the runners

